

A1 INSTALLATION DRAWING

IF THIS DOCUMENT IS PRINTED IN HARDCOPY, IT IS FOR INFORMATION USE ONLY AND THEREFORE IS NOT SUBJECT TO UPDATING CONTROLS. ALWAYS REFER TO SOLIDWORKS VIEWER FOR LATEST ISSUE



THIS DRAWING IS CONFIDENTIAL AND IS SUPPLIED ON THE EXPRESS CONDITION THAT IT SHALL NOT BE LOANED OR COPIED OR DISCLOSED TO ANY OTHER PERSON OR USED FOR ANY OTHER PURPOSE WITHOUT THE WRITTEN CONSENT OF AP RACING LTD.



AP Racing
 Wheeler Road
 Coventry
 CV3 4LB
 Tel: +44 (0) 24 7663 9595
 Fax: +44 (0) 24 7663 9559
 e-mail: engineering@apracings.co.uk
 Web site: http://www.apracings.com

© AP Racing Ltd. 2005

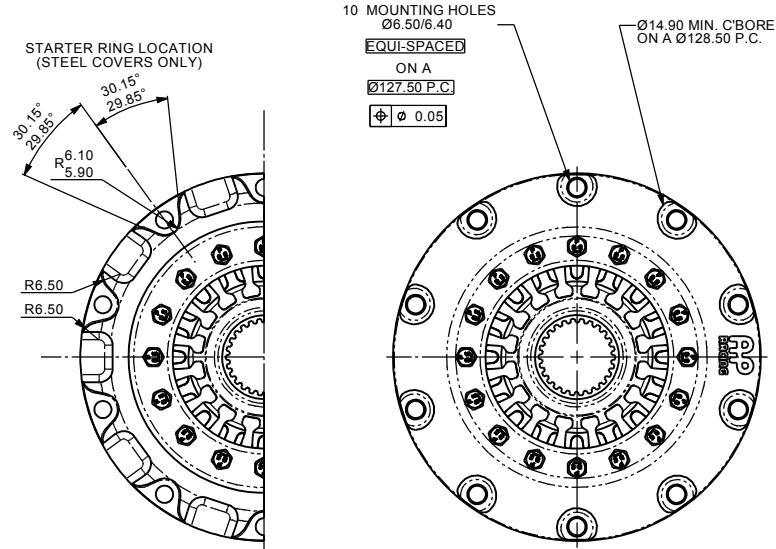

VIEW SHOWING A STEEL COVER

VIEW SHOWING AN ALUMINIUM COVER

RECOMMENDED CLUTCH MOUNTING :
 (FOR ALL TYPES OF ASSEMBLY)
 1/4" UNF, CP4703 FAMILY STUD AND
 K-LOCK NUT.
 TIGHTENING TORQUE : 10Nm (7.5 ft.lb)

LENGTH OF STUD REQUIRED TO BE
 CALCULATED THUS :

STUD LENGTH =
 DIMENSIONS 'C' + 'F' + NUT

THIS CALCULATED LENGTH TO BE ROUNDED
 UP TO THE NEXT AVAILABLE STANDARD STUD
 LENGTH.

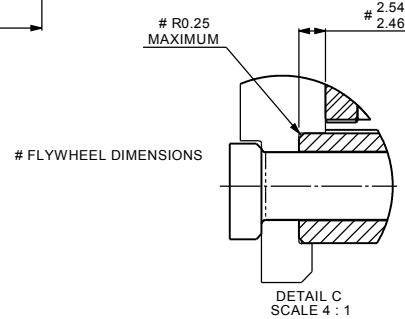
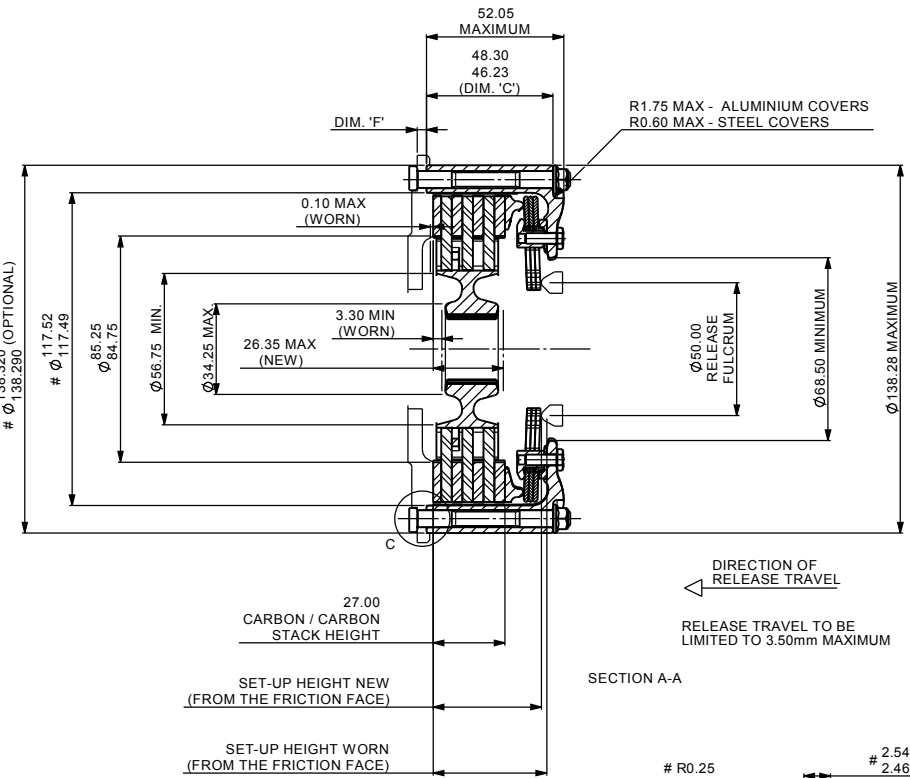

		HUB DETAILS		
HUB PART No.	HUB MAT'L	SPLINE DETAILS		
#	#	#		
CP5323-110S	STEEL	1.16" x 26T		

NOTE:
 THIS CLUTCH IS DESIGNED FOR 0.50mm MAX WEAR-IN WHICH MUST BE COMPENSATED FOR BY USING PRESSURE PLATES FROM EITHER OF THE KITS DETAILED ABOVE. MAXIMUM CARBON STACK WEAR IS 4.00mm DURING WHICH **AXIAL HUB FLOAT MUST BE MAINTAINED**

HUB MATERIAL SUFFIX: T = TITANIUM, S = STEEL
 ALUMINIUM HUBS AND PRESSURE PLATES ARE NOT RECOMMENDED.
 HUBS ARE AVAILABLE IN OTHER SPLINE SIZES

CLUTCH ASSY. PART No.	SET UP HEIGHT		RECOMMENDED MAX. DYNAMIC TORQUE CAPACITY Nm (lb/ft)	RELEASE LOAD (daN)		MASS (KG)				INERTIA	
	NEW	WORN		MAX. PEAK WORK	AT TRAVEL	CLUTCH ASSY		CLUTCH ASSY		D/PLATES & HUB.	
CP8153-SE02-SN	40.34 39.14	42.09 (0.50mm WEAR-IN)	758 (APPROX)	470	340	1.59 (ALUMINIUM COVER)	##	0.00365 (ALUMINIUM COVER)	##	0.000691	##
CP8153-DE02-SN	40.74 39.54	42.29 (0.50mm WEAR-IN)	848 (APPROX)	550	400	1.60 (ALUMINIUM COVER)	##	0.00368 (ALUMINIUM COVER)	##	0.000691	##
CP8153-SE03-SN	40.34 39.14	42.09 (0.50mm WEAR-IN)	758 (APPROX)	470	340	2.05 (STEEL COVER)	##	0.005307 (STEEL COVER)	##	0.000691	##
CP8153-DE03-SN	40.74 39.54	42.29 (0.50mm WEAR-IN)	848 (APPROX)	550	400	2.06 (STEEL COVER)	##	0.005310 (STEEL COVER)	##	0.000691	##

PRESSURE PLATE KITS (PART No. SUFFIX 'SN')	PRESSURE PLATE KIT DETAILS		PART No.
	KIT	CONTENTS	
	STANDARD	0.50 TO 3.50mm, 0.50mm INC.	CP8153-9SS
	INTERMEDIATE	0.25 TO 3.25mm, 0.50mm INC	CP8153-10SS
	LOW	0.25 TO 1.25mm, 0.25mm INC	CP8153-15SS
	MED	1.50 TO 2.50mm, 0.25mm INC	CP8153-16SS
	HIGH	2.75 TO 3.50mm, 0.25mm INC	CP8153-17SS

Issue No.	Alterations			Zone	Initials
	Date & No.	Particulars			
1	19/12/05 C2803	FIRST ISSUE		#	JG
2	24/01/06	CUSHION PRESSURE PLATE SECTION, CUSHION PRESSURE PART No.'S AND KITS DELETED. TORQUE CAPACITIES : 758 WAS 884 1014 WAS 848		#	JG
3	02/08/07 C3196	CP8153-SE03-SN AND STEEL COVER VIEW ADDED.		#	JG
4	10/10/07 C3232	WEAR IN WAS 0.75		#	JG
5	11/10/07 C3232	PRESSURE PLATE KIT CONTENTS MODIFIED IN LINE WITH WEAR IN CHANGE.		#	JG
6	24/10/07 C3232	CP8153-DE03-SN ADDED.		#	JG
7	29/10/07 C3232	Ø56.75 MIN, 3.30 MIN, 34.25 MAX, AND 0.10 MAX ADDED. Ø132.32/138.29 (OPTIONAL) ADDED.		#	JG
8	25/03/08 C3373	GEAR RING LOCATION DETAIL ADDED (STEEL COVER)		#	JG
9	03/11/08 C3522	PRESSURE PLATE KITS CP8153-15SS, -16SS AND -17SS ADDED. 'SS' ADDED TO CURRENT KITS -9 AND -10		#	JG

SCALE 1:1 SHEET 1 OF 1

DRAWN: Jeremy Govan

APPROVED:

DERIVED FROM:

TITLE
 Ø115mm CARBON CARBON
 CLUTCH ASSEMBLY

DRG NO. CP8153CD